

User Manual for Faculty First Time Login

Firstly, you need to click on the URL shared given below –

<https://mits.patthshala.com/>

1. Login into the portal with your provided email and default password.

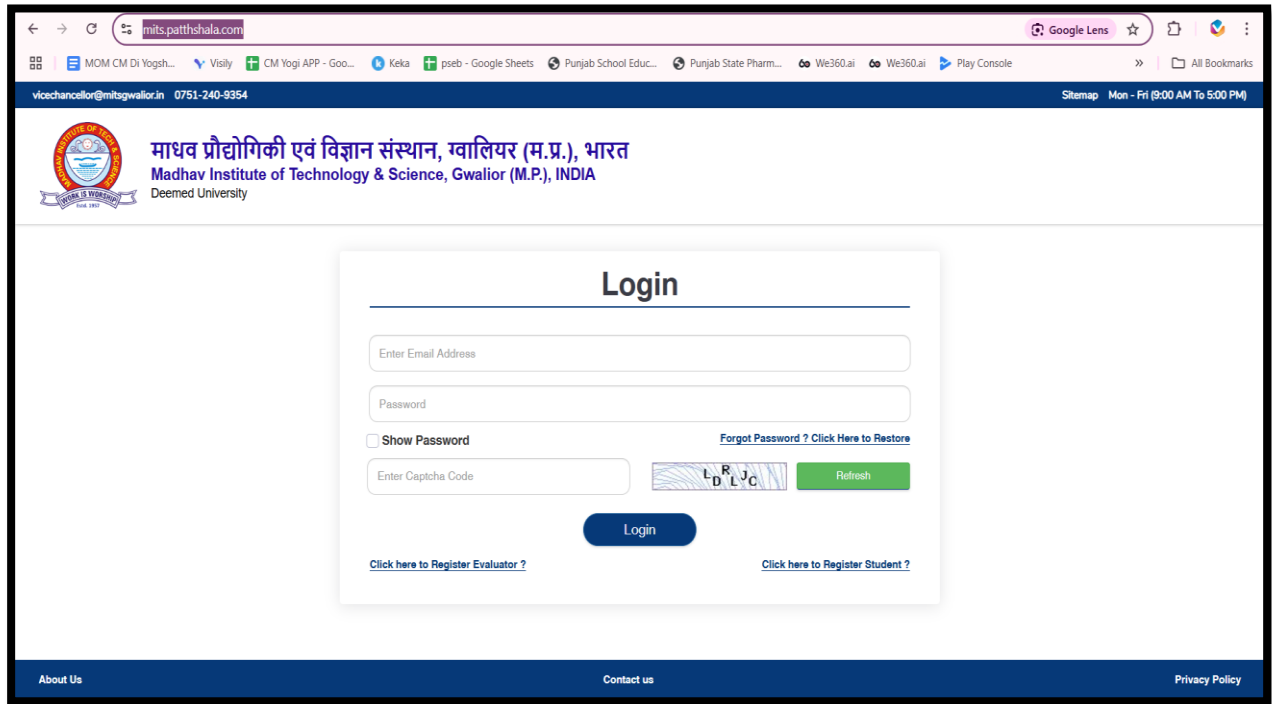

The screenshot shows the login interface of the Madhav Institute of Technology & Science (MITS) portal. The header includes the university's name in Hindi and English, its status as a Deemed University, and contact information. The main content area features a 'Login' form with fields for 'Enter Email Address', 'Password', and 'Enter Captcha Code'. There are links for 'Forgot Password ? Click Here to Restore', 'Click here to Register Evaluator ?', and 'Click here to Register Student ?'. A 'Login' button is positioned below the captcha field. The footer contains links for 'About Us', 'Contact us', and 'Privacy Policy'.

2. After filling your details, you will get an OTP on your registered mobile number.



The screenshot shows the OTP verification interface. The header is identical to the login page. The main content area features an 'OTP Verification' form. It displays the message 'Enter OTP received on Mobile No 942518XXXX' and a text input field labeled 'Enter OTP'. Below the input field, it states '(OTP Expires In: 29 seconds)'. There are two buttons: 'ReSend OTP' and 'Verify OTP'. The footer is also identical to the login page.

3. To change your password, click the option as shown

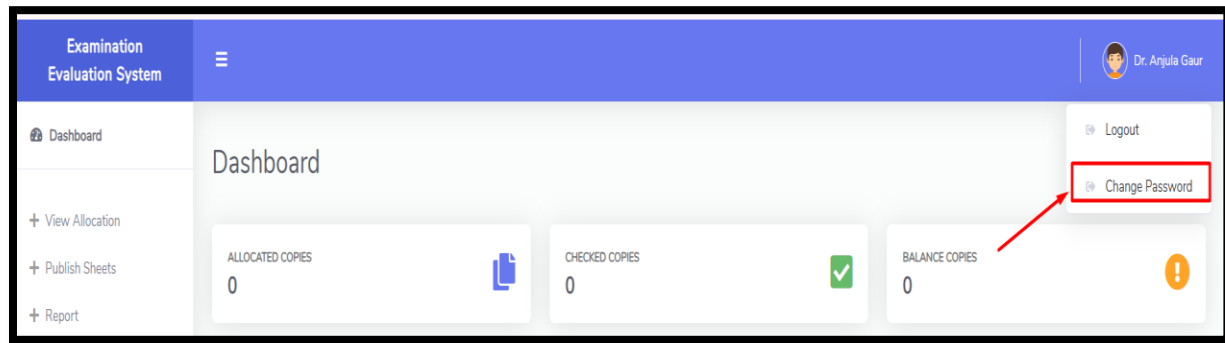

4. Now, confirm it by pressing change password button

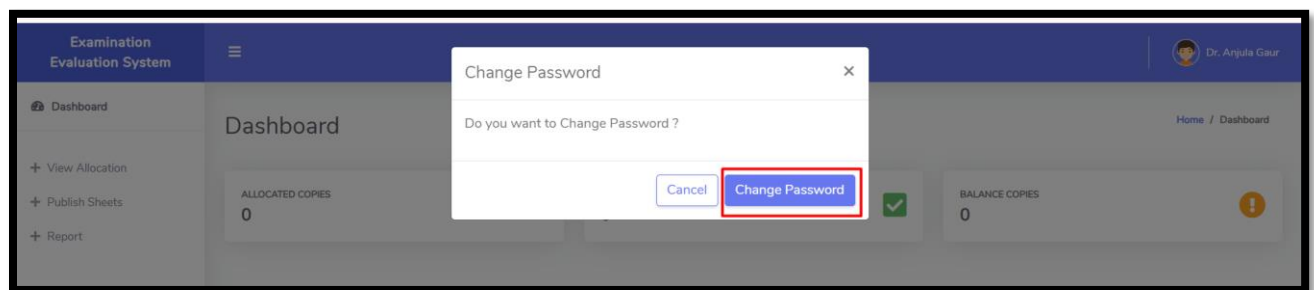

5. Enter your current password and new password twice at respective places, then click on submit button.

A screenshot of the 'Change Password' form. The form has three input fields: 'Enter Current Password', 'Enter Password', and 'Re-Enter Password'. Below these fields is a checkbox labeled 'Show Password'. At the bottom of the form is a blue 'submit' button.

Your Password has been changed. Thank You.